



700 Series Ball Valves

Applications

CNG Compressors, Dispensers, Priority Panels, Isolation Valves, CNG storage.

Suitable for use with CNG, Helium, Bio-Gas, Nitrogen, Air and other gases on enquiry.



BV708-4N6LDDN-1000 - 1" Ball Valve

Materials

Item	Part	Material
1	Body	304 Stainless steel
2	Cap	304 Stainless steel
3	Stem	316 Stainless steel
4	Ball	316 Stainless steel
5	Seats	Delrin

Item	Part	Material
6	Seat O-ring	Nitrile*
7	Gland & Thrust	Delrin
8	Body O-rings	Nitrile
9	Stem O-rings	Nitrile
10	Handle	304 Stainless Steel

* Seat O-ring only used on BV704 - BV706 - BV708 valves.

Product Information

Custom handle options available on request.

NPT/SAE threaded ports available from stock. Other thread types available upon request.

NGV4.6 Certified valve options available on request.

NPT threads conform to ASME B1.20.1.

SAE threads conform to SAE J1926-1.

All products are manufactured to ISO 9001 standards.

PED 97/23/EC approved.

Video servicing instructions available online at www.OasisNGV.com/resources.

Features & Benefits

The 700 Series Ball Valve is a FULL FLOW, Anti Blowout stem, all stainless steel certified bar stock, two-piece, serviceable valve.

Service kits are readily available & easy to install.

CNC machining allows tighter tolerances to be maintained, which extends the working life of the components.

The complete Oasis range has been cycle tested to ensure **LOWEST LIFE COST**.



700 Series Ball Valves

NPT Product Specification

Part Code	Mass lb (kg)	Min. Operating Pressure bar (psi) *	Max. Operating Pressure bar (psi) **	Min. Temp. °F (°C)	Max Temp. °F (°C)	Cycles Before Rekit [^]	Stem Open Torque ft-lb (Nm) ^{^^}	Cv	Service Kit
BV702-4N6SDDN-1000	0.7 (0.3)	34.5 (500)	410 (6000)	-40 (-40)	185 (85)	85,000	1.1 (1.5)	4.5	BV702-SK6SDDN
BV703-4N6SDDN-1000	0.9 (0.4)	34.5 (500)	410 (6000)	-40 (-40)	185 (85)	100,000	2.2 (3)	9.3	BV703-SK6SDDN
BV704-4N6LDDN-1000	1.3 (0.6)	0.5 (7)	410 (6000)	-40 (-40)	185 (85)	100,000	10.3 (14)	12.3	BV704-SK6LDDN
BV706-4N6LDDN-1000	3.7 (1.7)	0.5 (7)	410 (6000)	-40 (-40)	185 (85)	100,000	22.8 (31)	31	BV706-SK6LDDN [#]
BV708-4N6LDDN-1000	6.2 (2.8)	0.5 (7)	410 (6000)	-40 (-40)	185 (85)	100,000	32.4 (44)	44.5	BV708-SK6LDDN

- * Minimum system pressure the product will hold constant bubble tight seal.
- ** Maximum pressure at which the product can constantly operate at.
- [^] It is recommended that the ball valve is re-kitted on or before the maximum number of allowable cycles.
- [#] For obsolete valve BV706-4NSDDN use BV706-SKSDDN service kit only.
- ^{^^} Opening torque at 6,000 psi

SAE Product Specification

Part Code	Mass lb (kg)	Min. Operating Pressure bar (psi) *	Max. Operating Pressure bar (psi) **	Min. Temp. °F (°C)	Max Temp. °F (°C)	Cycles Before Rekit [^]	Stem Open Torque ft-lb (Nm) ^{^^}	Cv	Service Kit
BV704-4S6LDDN-1000	1.3 (0.6)	0.5 (7)	410 (6000)	-40 (-40)	185 (85)	100,000	10.3 (14)	12.3	BV704-SK6LDDN-S
BV706-4S6LDDN-1000	3.7 (1.7)	0.5 (7)	410 (6000)	-40 (-40)	185 (85)	100,000	22.8 (31)	31	BV706-SK6LDDN-S
BV708-4S6LDDN-1000	6.2 (2.8)	0.5 (7)	410 (6000)	-40 (-40)	185 (85)	100,000	32.4 (44)	44.5	BV708-SK6LDDN-S

- * Minimum system pressure the product will hold constant bubble tight seal.
- ** Maximum pressure at which the product can constantly operate at.
- [^] It is recommended that the ball valve is re-kitted on or before the maximum number of allowable cycles.
- ^{^^} Opening torque at 6,000 psi

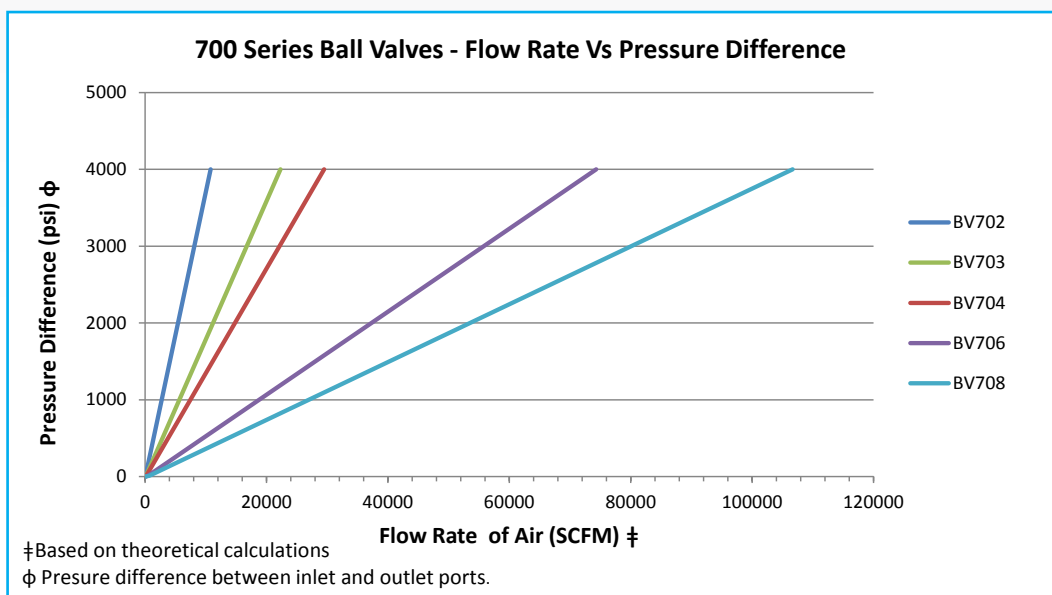

We reserve the right to modify product specifications without prior notice.



700 Series Ball Valves

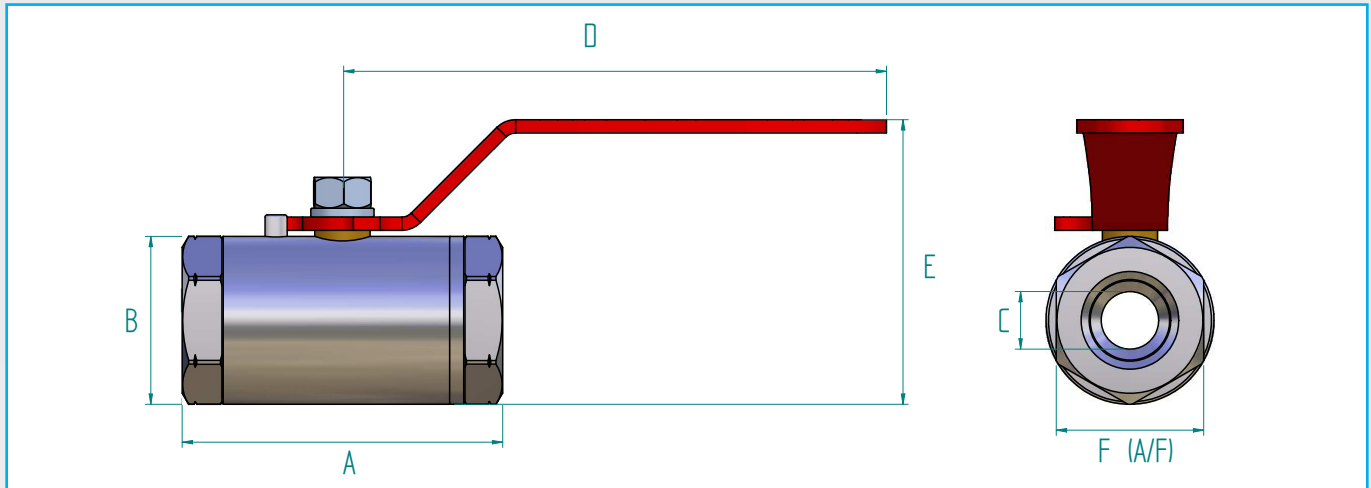

NPT Dimensions Inch (mm)

Part Code	Size	A	B	Ø C	D	E	Port Thread	F (A/F)
BV702-4N6SDDN-1000	1/4"	1.96 (50)	1.1 (28)	.275 (7)	3.54 (90)	1.93 (49)	1/4" NPT FEMALE	1 (25)
BV703-4N6SDDN-1000	3/8"	2.32 (59)	1.25 (32)	.39 (10)	4.9 (125)	2.28 (58)	3/8" NPT FEMALE	1.1 (28)
BV704-4N6LDDN-1000	1/2"	2.87 (73)	1.5 (38)	.5 (13)	4.9 (125)	2.56 (65)	1/2" NPT FEMALE	1.3 (33.4)
BV706-4N6LDDN-1000	3/4"	3.9 (100)	2.16 (55)	.78 (20)	6.9 (177)	3.5 (89)	3/4" NPT FEMALE	1.9 (48)
BV708-4N6LDDN-1000	1"	4.2 (108)	2.72 (69)	1 (26)	6.9 (177)	4 (102)	1" NPT FEMALE	2.3 (60)

SAE Dimensions Inch (mm)

Part Code	Size	A	B	Ø C	D	E	Port Thread	F (A/F)
BV704-4S6LDDN-1000	1/2"	2.87 (73)	1.5 (38)	.5 (13)	4.9 (125)	2.56 (65)	3/4-16 SAE FEMALE	1.3 (33.4)
BV706-4S6LDDN-1000	3/4"	3.9 (100)	2.16 (55)	.78 (20)	6.9 (177)	3.5 (89)	1 1/16-12 SAE FEMALE	1.9 (48)
BV708-4S6LDDN-1000	1"	4.2 (108)	2.72 (69)	1 (26)	6.9 (177)	4 (102)	1 5/16-12 SAE FEMALE	2.3 (60)