

SEE EXPLODED

SEE BOTTOM VIEW FOR DEPTH

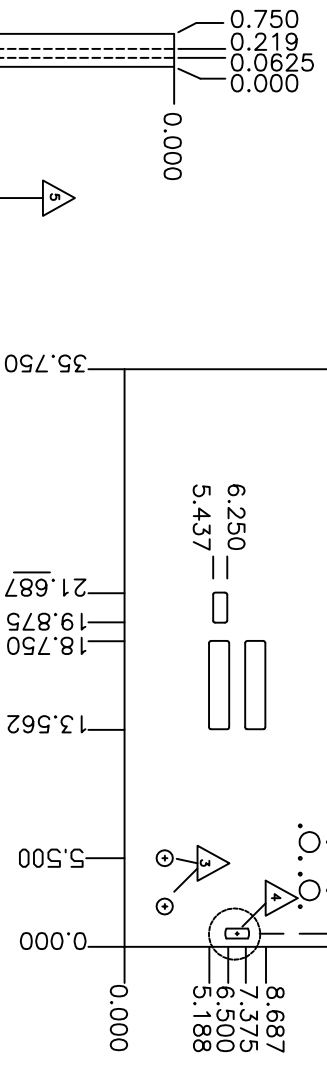

FRONT VIEW

REPRESENT HOLE AND HINGE RELATIONS

HINGE WELDED TO BACK INNER SIDE OF PANEL SEE DETAIL.

KEYWAY EXPLODED VIEW

KEYWAY IS 5/8" (.625) X 3/4" (0.75) WITH A RADIUS OF 3/4" ON EITHER END. PLACEMENT IS CENTERED OFF THE FRONT RIGHT EDGE AS DIMENSIONED ABOVE.

WINDOW SLOTS REQUIRE AN 1/8" (.1250) RADIUS ON ALL CORNERS.

STUDS ARE 7/32" (.2187) Ø, AND PLACED AS DIMENSIONED. STUDS ARE 1" (1.00) IN HEIGHT.

HOLE IS Ø 7/8" (.875) FOR PUSH BUTTON PLACEMENT.

SLOTTED HOLE 3" X 7/32" PLACED AS DIMENSIONED

HINGE PIECES BOTH SIDES OF INNER SIDE OF PANEL. HOLES OF HINGE PIECES MUST MEET IN RELATIONS WITH 1/4" DIA. HOLES ON TOP AND BOTTOM SIDES OF THE PANEL.

10-32 X 3/4" STAINLESS STEEL STUD (2.00, 1.87 FROM BOTTOM RIGHT EDGE OF INSIDE).

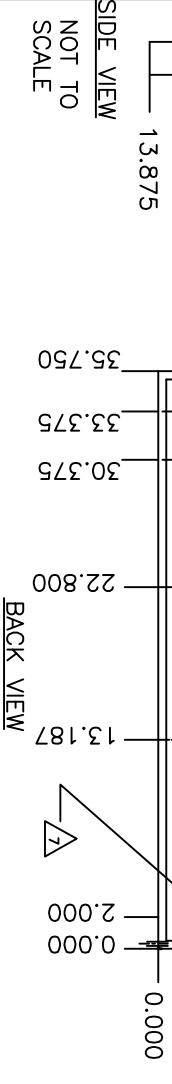

NOT TO SCALE

HINGE TO HOLE RELATIONSHIP. HOLES THRU MATERIAL ON TOP AND BOTTOM EDGES SHOULD MATCH WITH HOLES ON HINGE PIECES TO ENSURE PROPER HINGE SWING

TOLERANCES

.X +/- .06
.XX +/- .03
.XXX +/- .015
ANGLES +/- 1

SEE BILL FOR DETAIL NOTES

0.000	3.000	6.000
SCALE		
0.50" (1/2") = 6" or .5 MU = 6 DU		
SHOWN IN DECIMAL INCHES		

NOTE: POST-FABRICATION DETAILING NOT SHOWN ON THIS DRAWING:
 (1) Company Decals
 (2) Push Button Installation
 (3) Electronics

MATERIAL IS COLD ROLLED STEEL.

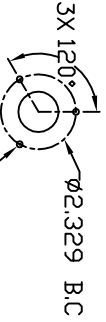

DETAIL A
3X Ø0.19
TYP 2 PLCS

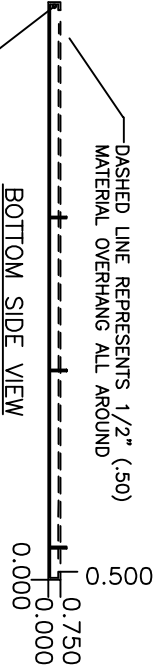

BOTTOM SIDE VIEW

DASHED LINE REPRESENTS 1/2" (.50) MATERIAL OVERHANG ALL AROUND

Ø1/4" thru both sides

TOP SIDE VIEW

HINGE SWING POINT



TULSA GAS TECHNOLOGIES, INC.
 4809 South 101st East Avenue
 Tulsa, OK 74146
 (918) 665-2641

MODEL: TGT-7000-DH100	DRAWN BY: TC	DATE:
SEQUENCE: -	CHECKED BY: -	02-08-17
PROGRAM: -	APPROVED BY: -	
SERIAL NO.: -	PART: FACE PLATE	
WORK ORDER: -	DWG/PART NO.:	
NOTE A: Weld and grind smooth.		

TGT-7010FP1 TRILLIUM M002